

## General Information

Reusable earplugs against harmful noise (EN 352-2:2020, EN 2016/425).

Product certification: PZT GmbH (1974), Bismarckstraße 264B, 26389 Wilhelmshaven, Germany.

Product monitoring: IFA Institut für Arbeitsschutz der DGUV (0121), Alte Heerstraße 111, 53757 St. Augustin, Germany.

**Material:** TPE

**Colour:** Transparent earplug and filter in yellow colour

**Size:** Ø 7-12 mm (Size M) and Ø 6-11 mm (Size S)

**Characteristics:** Earplugs with patented filter for an even sound attenuation when listening to music.

**Instructions:** IN-Ear plug (to be inserted into the ear canal)

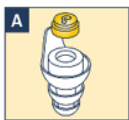

The earplugs consist of two parts: the coloured, round filter and the transparent earplug. The filter already comes delivered inside the larger earplug (M: Ø 7-12 mm). First, insert these earplugs into your ear canal in accordance with the instructions. If this is difficult or feels uncomfortable, try again with the slightly smaller earplugs (S: Ø 6-11 mm).

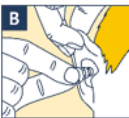

Use one hand to pull the outer ear slightly outwards and upwards, and then carefully insert the earplug into the ear canal until it is in a secure and comfortable position.

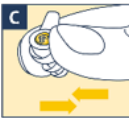

To remove the filter, press the earplug just under the filter until it 'pops' out of the earplug.



To insert the filter, ease it into the larger opening of the earplug with the ear symbol facing outwards. The filter should be inserted at a slight angle and upside down. Then, push the ear symbol downwards a little to ensure the filter is correctly positioned inside the hollow area. The filter can only provide the certified noise-reducing effect if it is inserted correctly!

**Removal:** Remove the plug carefully with your fingers. Do not use any auxiliary means!

## Sound Attenuation (EN ISO 4869-2)

Frequency Hz	125	250	500	1000	2000	4000	8000
Mean value dB	15,1	15,4	17,1	19,9	26,9	17,7	29,9
Standard deviation dB	3,7	2,5	3,3	2,4	3,0	2,2	5,5
Assumed protection value dB	11,4	12,9	13,8	17,5	23,9	15,5	24,4
	<b>SNR</b>	<b>H</b>	<b>M</b>	<b>L</b>			
Mean value dB	20,6	21,2	19,0	16,8			
Standard deviation dB	1,5	2,0	1,7	1,6			
<b>Value dB</b>	<b>19</b>	<b>19</b>	<b>17</b>	<b>15</b>			

## Further Information

- Insert the earplugs as described and check that they fit correctly.
- Ensure hygienic use. Your hands, ears and earplugs should be clean and dry!
- The earplugs should be regularly inspected for usability as well as for the necessity of cleaning.
- Replace soiled or damaged earplugs or such plugs that have become less effective.
- Cleaning: Light impurities can be carefully wiped off with a damp cloth a deeper clean with soap or hygiene tablets, remove the filter first, thoroughly and wait until completely air-dried.
- Wear earplugs at all times in noisy environments.
- Sudden or fast removal of the earplug out of the ear canal may damage the eardrum.
- This product may be adversely affected by certain chemical substances.  
Further information can be sought from the manufacturer.
- Failure to comply with these instructions may significantly impair the protective effect of the product.
- Keep away from small children (danger of swallowing).
- Can be used by children aged six and older; use only under adult supervision.
- Storage: In the box, dry and protected from heat.

## Application Areas

**For private use:** OHROPAX® music are the ideal earplugs for air travel, for rest and pressure equalization, but also when you are exposed to noise in your leisure time.

### At work:

- OHROPAX® music can also be used for workplaces in the so-called non-traditional noise areas such as open-plan offices and computer centres (Noise level <75 dB (A)).
- OHROPAX® music is immediately ready for use. There is no need to wait for expansion times as with foam plugs.
- No wearing problems for spectacle wearers.
- Can be combined with safety helmets, goggles and capsule hearing protectors.
- Speech and warning signals are still perceived. Sound is attenuated, but not completely excluded.

## Suitability

Before using the product in noisy environments, first check whether the plug is suitable for this load. Take into account the special notes, the sound attenuation values and please also see the [information on sound attenuation values and protective effect](#).

## Tolerability

OHROPAX® music is considered to be extremely well tolerated. Components with known allergenic potential are not included. Sometimes you have to get used to hearing protection. We recommend increasing the wearing time gradually. In rare cases, you can initially hear your own pulse. This effect usually disappears after a short period of habituation.